

CITY OF LOS ANGELES
CALIFORNIA



DEPARTMENT OF CITY PLANNING

NOTICE OF PUBLIC HEARING

To Owners: Within a 100-Foot Radius
 Within a 500-Foot Radius
 Abutting a Proposed Development Site

And Occupants: Within a 100-Foot Radius
 Within a 500-Foot Radius
And: Others

This notice is sent to you because you own property or are an occupant residing near a site for which an application, as described below, has been filed with the Department of City Planning. All interested persons are invited to attend the public hearing at which you may listen, ask questions, or present testimony regarding the project.

Hearing By: Advisory Agency
Date: Tuesday, October 5, 2010
Time: 9:30 AM
Place: Marvin Braude San Fernando Valley
Constituent Services Center
6262 Van Nuys Boulevard, Room 1B
Van Nuys, CA 91401

Staff Contact: Sarah Hounsell
Phone No.: (818) 374-9909

Case No.: AA-2010-2114-PMLA
CEQA No.: EIR-88-0026(SP)(ZC)(PA)
Incidental Cases: None
Related Cases: VTT-54153, VTT-54153-M1,
DIR-2003-8057-DRB-SPP
12
Council No.:
Plan Area: Chatsworth-Porter Ranch
Specific Plan: Porter Ranch Land Use/
Transportation Specific Plan
Certified NC: Porter Ranch
GPLU: Community Commercial
Zone: [T]C4-2D
Applicant: Porter Ranch Development
Company
Representative: Tom Stemnock; Planning
Associates, Inc.

PROJECT LOCATION: 20355 West Sorrento Lane, 11300 North Mason Avenue

PROPOSED PROJECT: Re-merger and subdivision to create two new parcels.

REQUESTED ACTION: The Deputy Advisory Agency will consider: Pursuant to LAMC Section 17.50, a Preliminary Parcel Map for the subdivision of one lot into two parcels for subdivision purposes only on a 872,497 square-foot site in the [T]C4-2D Zone. Lot No. 1 of Tract No. VTT-54153-02-C is proposed to be subdivided into two parcels with 88 senior apartments on Parcel A and 310 market-rate apartments on Parcel B for a total of 398 dwelling units. There will be no change in the total number of dwelling units previously approved.

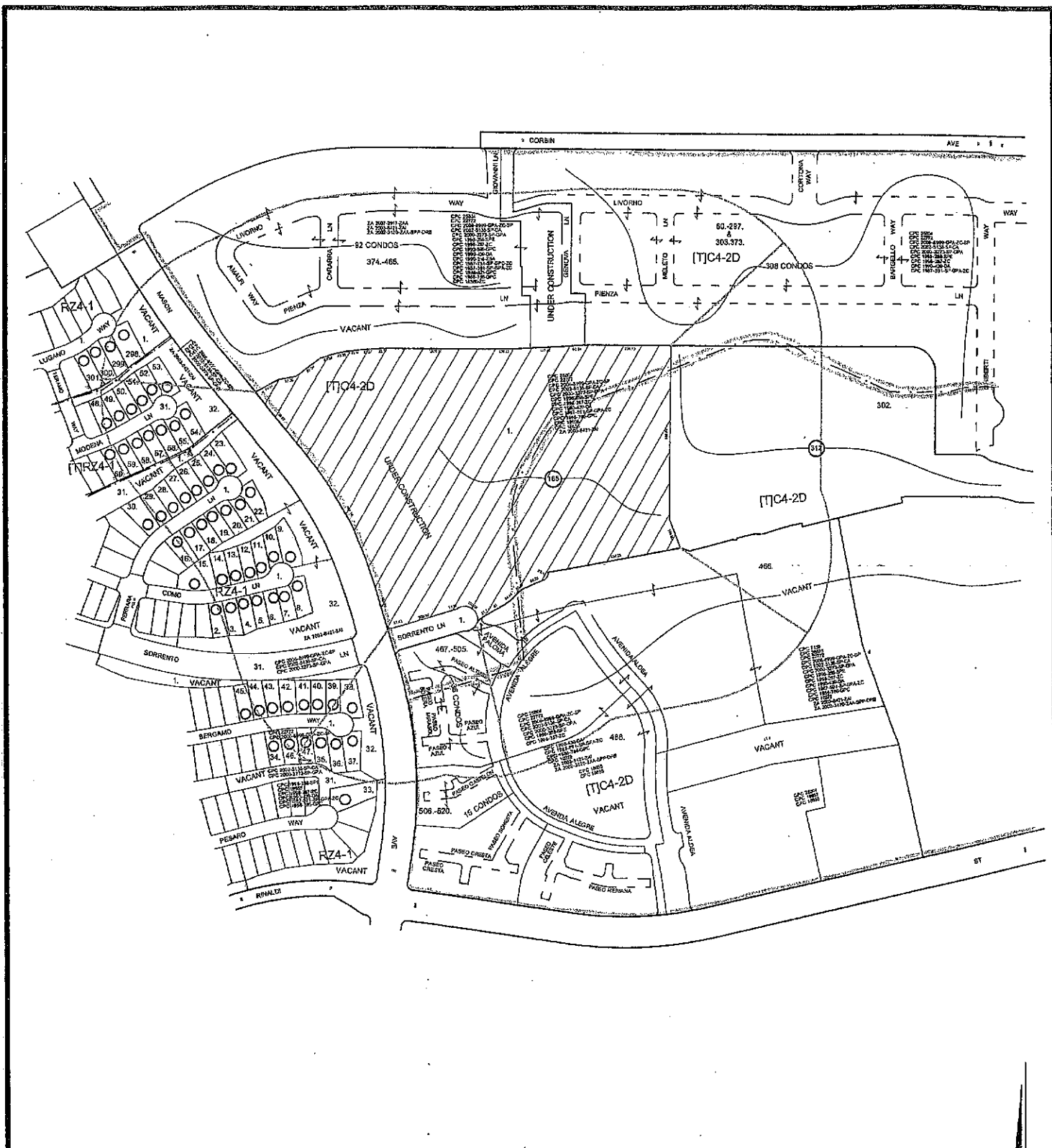

LEGAL: LOT 1, C-TRACT NO. 54153-02

PRELIMINARY PARCEL MAP

C.D. 12
 C.T. 1082.00
 P.A. CHATSWORTH-PORTER RANCH

GC MAPPING SERVICE, INC.

3055 WEST VALLEY BOULEVARD
 ALHAMBRA CA 91803
 (626) 441-1080 FAX (626) 441-8850
 gcmapping@radiusmaps.com

19.85 NET AC.

CASE NO.
 DATE: 06-22-2010
 SCALE: 1" = 200'
 USES FIELD
 D.M. 213 B 109, 213 B 113,
 210 B 109, 210 B 113
 T.B. PAGE: 500 GRID: D-1